

# Insulation screw plug IPSD-H 55

## Advantages

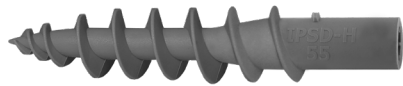

- Special screw plug for direct fastening into wood fibre insulation boards - extremely fast and without thermal bridges!
- For fastening of wall connection profiles, metal sheets, base protection profiles, cornice covers, motion detectors, lamps, signs, etc. into the insulation material
- To be used with plumber screws 4,5x25 mm
- Pre-drilling in plaster usually not necessary ( $\leq 7$  mm) due to sharp drilling tip
- Length only 55 mm; therefore also perfectly suitable for small insulation thicknesses (from 60 mm)
- Suitable for clearance holes  $\geq \varnothing 8$  mm (common for wall connection profiles)
- Made out of glass-fibre reinforced nylon
- Clean sealing against driving rain up to wind force 11 (violent storm) in combination with plumber screw PLS, tested according to DIN EN 1027, no reworking required

## Suitable building materials

### Very suitable



- Wood fibre boards
- Perimeter insulation panels



## Approvals and certificates



Tested for driving rain tightness by the  
Prüfzentrum für Bauelemente (Germany)

## Mounting

### Wall connection profiles

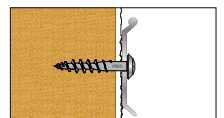
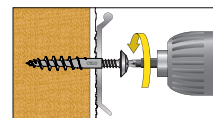
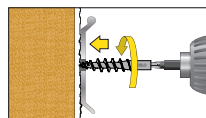

Recommended plumber screw: 4,5x25 mm

### Light duty fixings with screw

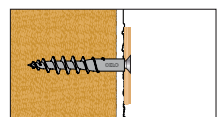
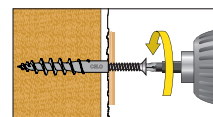
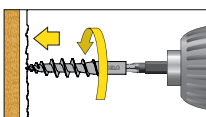

Usable with: Screw  $\varnothing 4,5$  mm;  
Screw length  $L_s = 10$  mm + Thickness of fixture

## Insulation screw plug IPSD-H

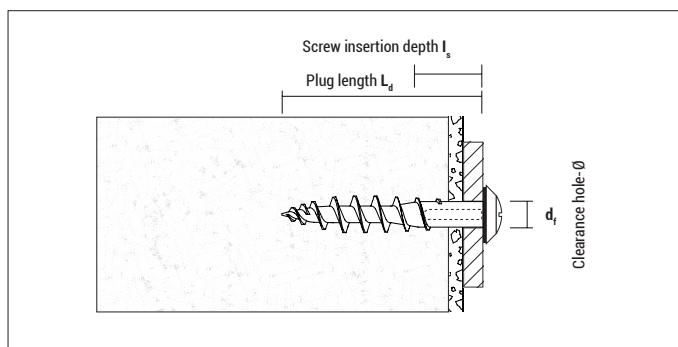

IPSD-H 55

Type	Art-No	$L_d$ [mm]	$I_s$ [mm]	Drive	$d_f$ [mm]	€ / 100 pcs	[pcs]	[pcs]
IPSD-H	9GR55IPSDH	55	20	TX 25	min. 8		50	1.350

Plumber screw PLS TX sealing washer  $\varnothing = 15,0$  mmA2  
STAINLESS  
STEEL

Type $d_0 \times L_s$	Art-No	Material	$d_0$ [mm]	$L_s$ [mm]	Drive	€ / 100 pcs	[pcs]	[pcs]
4,5 x 25	9X4525PLST	Stainless steel A2	4,5	25	TX 25		50	1.200
4,5 x 25	9XCO4525PLST	Stainless steel A2, copper plated	4,5	25	TX 25		50	1.200

## Loads and dimensions

Type	Applications in wood fibre insulation boards unplastered $F_{rec}$ [kN]	Applications in wood fibre insulation boards plastered $F_{rec}$ [kN]	Applications in Polystyrene XPS (perimeter insulation) $F_{rec}$ [kN]	Thickness of insulation material $\geq$ [mm]
IPSD-H	0,10*	ca. 0,12*	0,07*	60

$F_{rec}$ : Recommended load in all directions incl. safety factor of 5

\* Value may differ depending on wood fibre board type as well as type and thickness of the plaster